

# NORFOLK 1500 DB CLASSIC FLOOR VANITY

## PRODUCT SPECIFICATIONS



### CABINET

INSTALLATION	Floor Standing
CONFIGURATION	2 soft-close Drawers & 2 soft-close Doors
MATERIAL	Moisture Resistant Board
WIDTH (mm)	1490
DEPTH (mm)	445
HEIGHT (mm)	830
ORIGIN	Aotearoa / New Zealand

### VANITY TOP - Double Bowl

FINISH	Gloss White
MATERIAL	Composite
TAP HOLE	Yes
OVERFLOW	No
WASTE SIZE	Suits 32mm and 40mm waste traps
WASTE INCLUDED	No
WIDTH (mm)	1500
DEPTH (mm)	460
ORIGIN	PRC
STANDARD APPROVAL	AS/NZS 1730:1996

### PRODUCT CODES & FINISHES



5NOR15DFL01

White Melamine



5NOR15DFL02

Ultra Gloss White -  
Front Panels Only



5NOR15DFL23

Baroque



5NOR15DFL25

Premium Oak



5NOR15DFL30

Hickory Walnut



5NOR15DFL31

Blackened Elm



5NOR15DFL32

Rural Oak



5NOR15DFL82

Nordic Ash



5NOR15DFL93

Charred Oak



5NOR15DFL95

Dark Oak

### NOTES

- 5 year warranty \*
- Cabinets made from moisture resistant board with PUR bonding technology are sustainably sourced from FSC certified NZ Radiata Pine.
- Included - Internal Shelf. (see Tech Specs.)
- Included - Brushed Nickel handle(s).
- Optional Upgrade - Black or Gunmetal handle(s). \*\*
- Optional - Pop-Up Waste. \*\*

ALL MEASUREMENTS ARE NOMINAL.

\*WARRANTIES APPLY TO RESIDENTIAL DOMESTIC USE ONLY. WARRANTY VOID IF PRODUCT IS NOT INSTALLED ACCORDING TO OUR SPECIFICATIONS.

\*\*FOR FURTHER INFORMATION ON INSTALLATION GUIDE AND PRODUCT OPTIONS PLEASE REFER TO THE WEBSITE.

CLEARLITE.CO.NZ

# NORFOLK 1500 DB CLASSIC FLOOR VANITY

## TECHNICAL SPECIFICATIONS

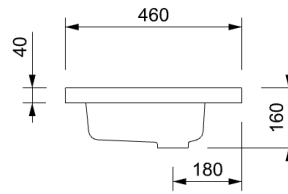
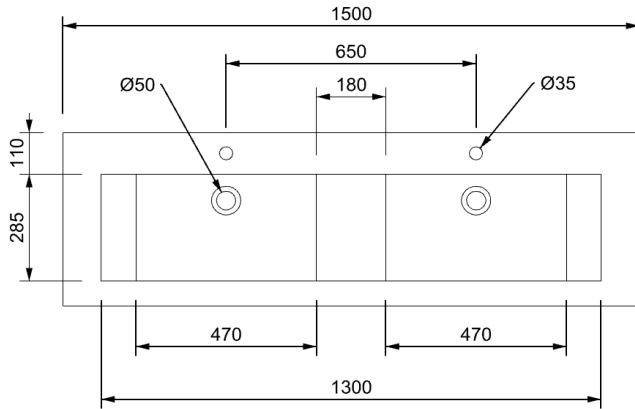

Internal Basin Depth  
130 mm

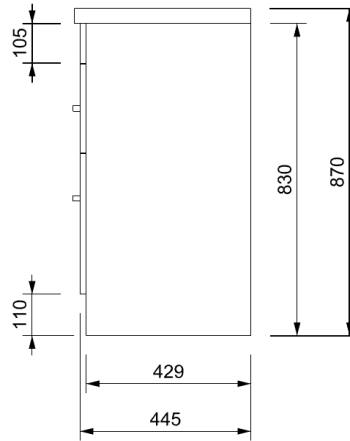
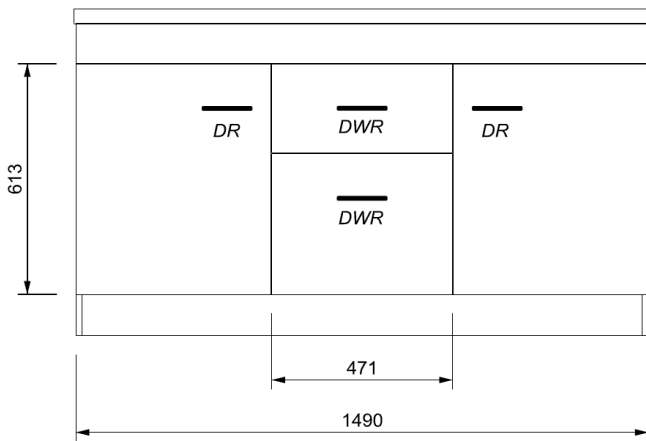

ALL MEASUREMENTS ARE NOMINAL.

\*WARRANTIES APPLY TO RESIDENTIAL DOMESTIC USE ONLY. WARRANTY VOID IF PRODUCT IS NOT INSTALLED ACCORDING TO OUR SPECIFICATIONS

\*\*FOR FURTHER INFORMATION ON INSTALLATION GUIDE AND PRODUCT OPTIONS PLEASE REFER TO THE WEBSITE.

[CLEARLITE.CO.NZ](http://CLEARLITE.CO.NZ)