

SPECIFICATION SHEET

Harrow 1500 4-Drawer Double Basin Wall Hung Vanity



Features

- 4-Drawer Wall Hung Vanity - *Colour options below*
- StoneCast 20mm Via Single Basin [Standard]
- Full Extension Soft Close Drawers with Handles - *Handle upgrade options available*
- Dimensions: H670 x W1500 x D465

Cabinet Options

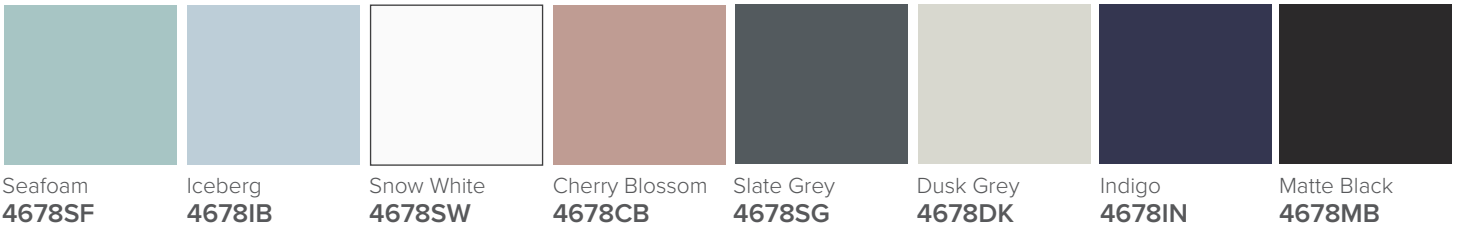

Technical Details

Note: All measurements shown are in millimetres. Sizes are nominal.

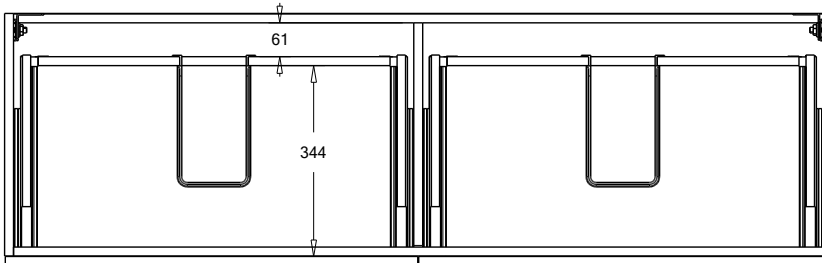

TOP VIEW

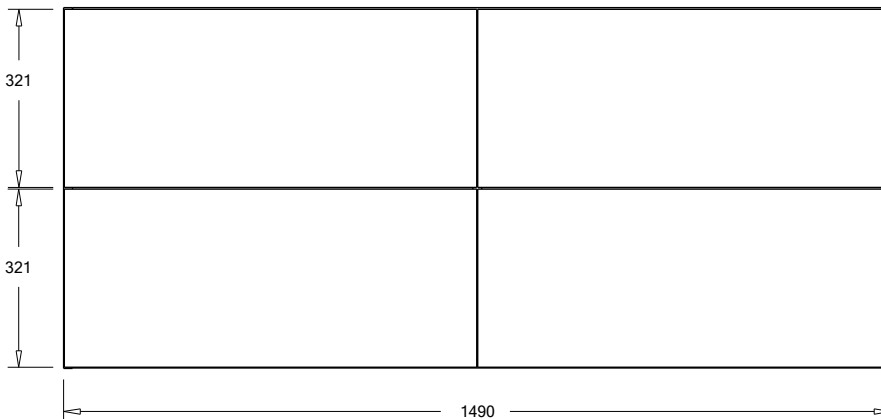
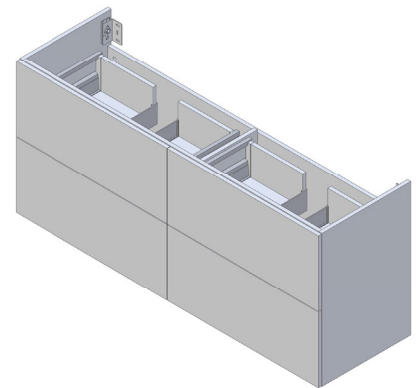

FRONT VIEW

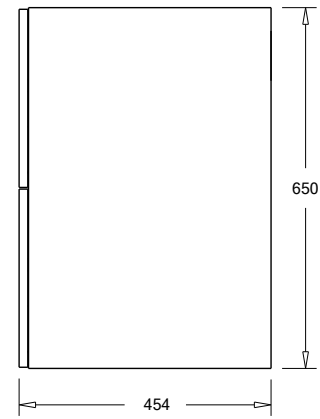

SIDE VIEW