

SPECIFICATION SHEET

Porscha 1500 4-Drawer Double Basin Wall Hung Vanity



Features

- 4-Drawer Wall Hung Vanity - *Colour options below*
- StoneCast 20mm Via Single Basin [Standard]
- Full Extension Soft Close Drawers with Extrusions - *Extrusion upgrade options available*
- Designer Drawer Fronts - *Four Drawer Front options*
- Dimensions: H670 x W1500 x D465

Cabinet Options

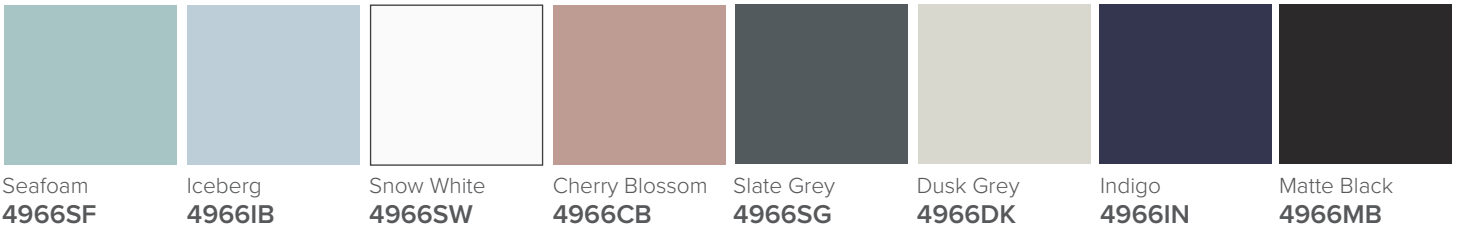

Technical Details

Note: All measurements shown are in millimetres. Sizes are nominal.

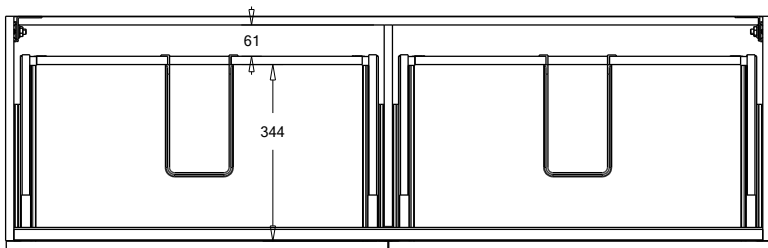

TOP VIEW

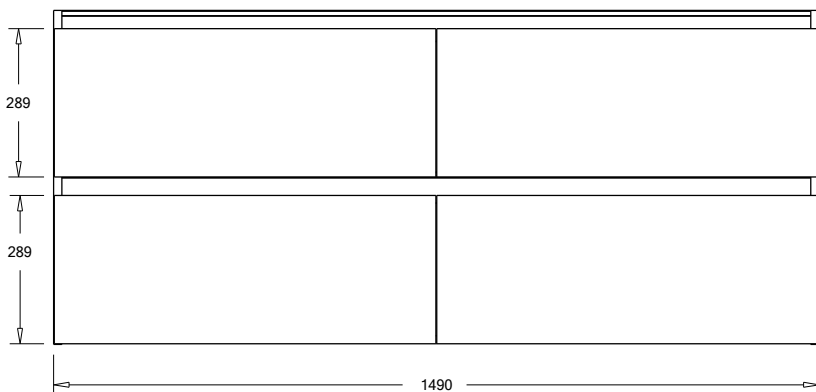
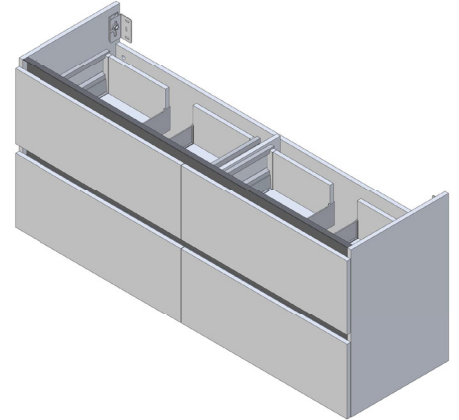

FRONT VIEW

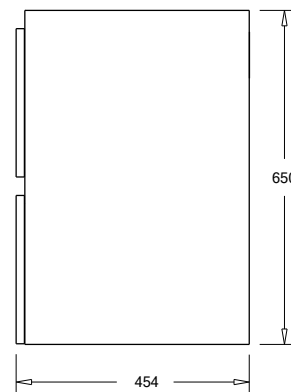

SIDE VIEW

SPECIFICATION SHEET

Porscha Designer Drawer Fronts

BARNSLEY
18mm Inset Frame
Code: BL

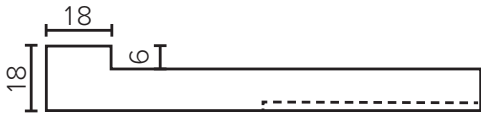
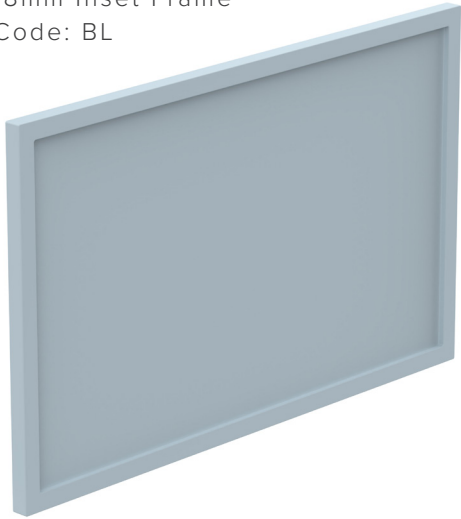

PRESTON
60mm Inset Frame
Code: PT

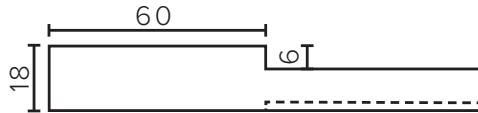
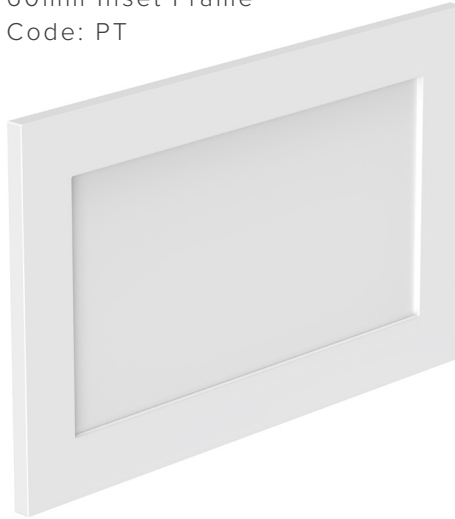

TURNBERRY
Ripple Design Panel
Code: TB

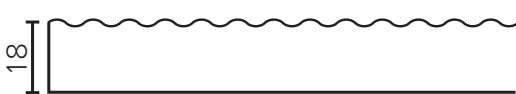
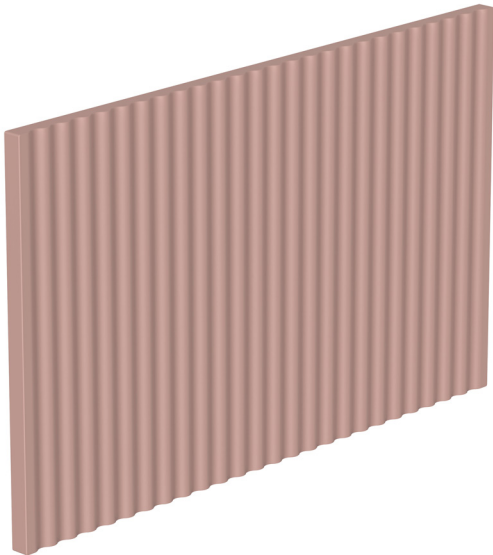

NEWPORT
V-Groove Panels
Code: NP

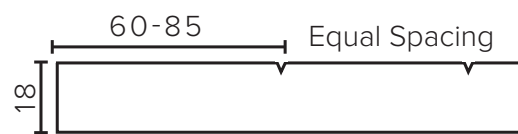
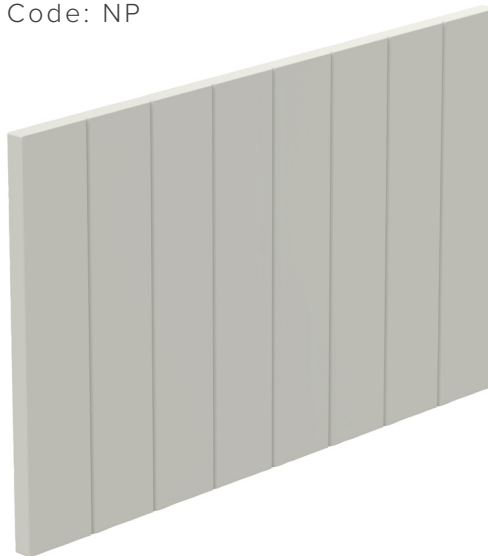

Seafoam

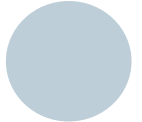

Iceberg

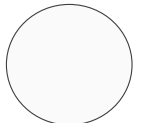

Snow White



Cherry Blossom



Slate Grey



Dusk Grey



Indigo



Matte Black

SPECIFICATION SHEET

1500mm Double Basin Options

Via

StoneCast with overflow
Double Basin Option
Gloss White - VIA
Matte White - VIAMW

W1500 x D460 x H20

