

# SPECIFICATION SHEET

## Porscha 1500 4-Drawer Single Basin Wall Hung Vanity



### Features

- 4-Drawer Wall Hung Vanity - Colour options below
- StoneCast 20mm Via Single Basin [Standard]
- Full Extension Soft Close Drawers with Extrusions - Extrusion upgrade options available
- Designer Drawer Fronts - Four Drawer Front options
- Dimensions: H670 x W1500 x D465

### Cabinet Options

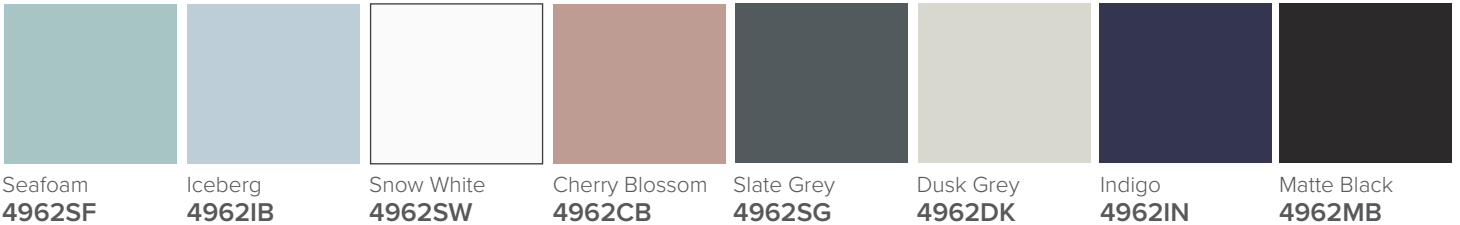

### Technical Details

Note: All measurements shown are in millimetres. Sizes are nominal.

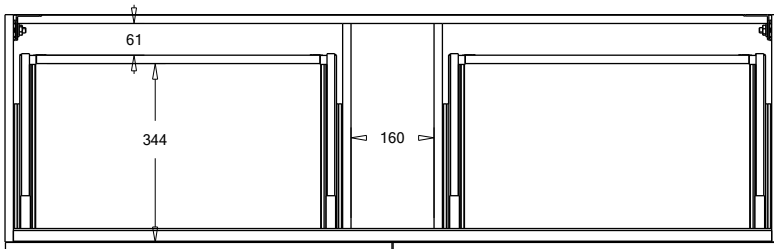

TOP VIEW

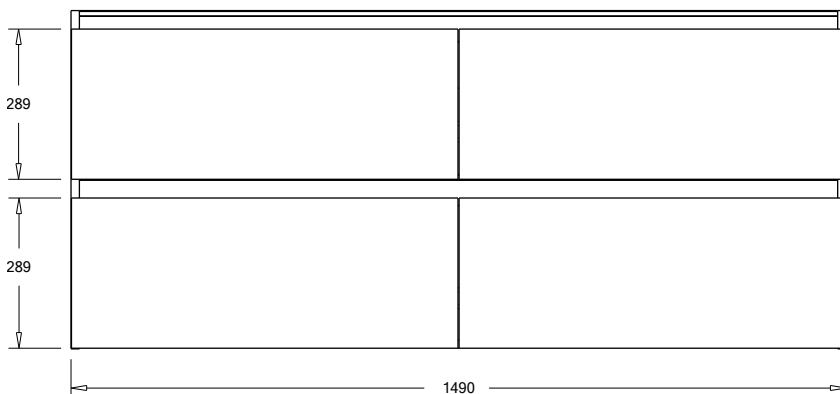
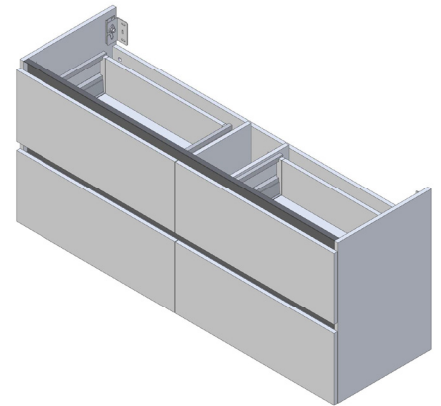

FRONT VIEW

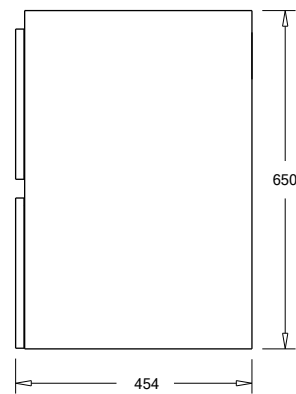

SIDE VIEW

# SPECIFICATION SHEET

## Porscha Designer Drawer Fronts

BARNSLEY  
18mm Inset Frame  
Code: BL

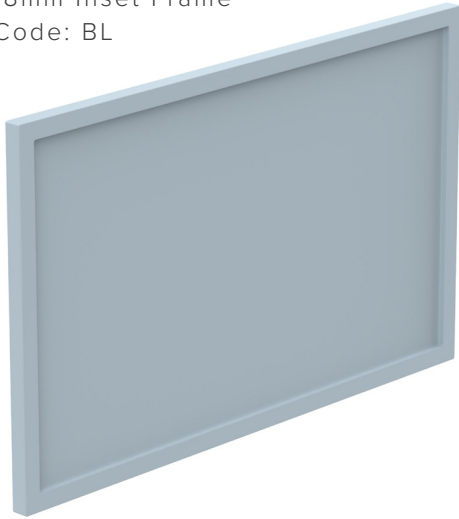

PRESTON  
60mm Inset Frame  
Code: PT

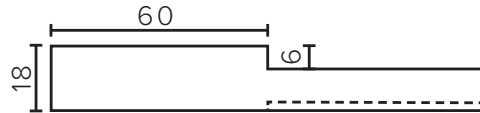
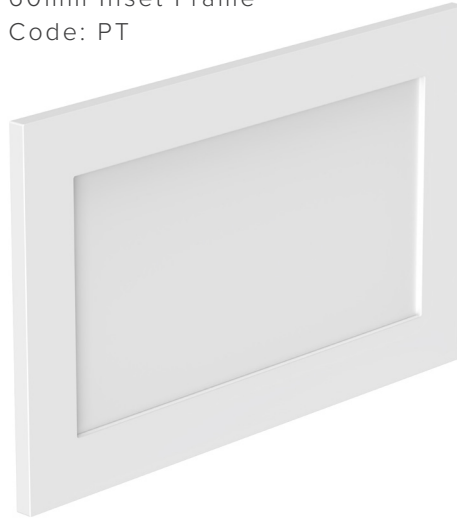

TURNBERRY  
Ripple Design Panel  
Code: TB

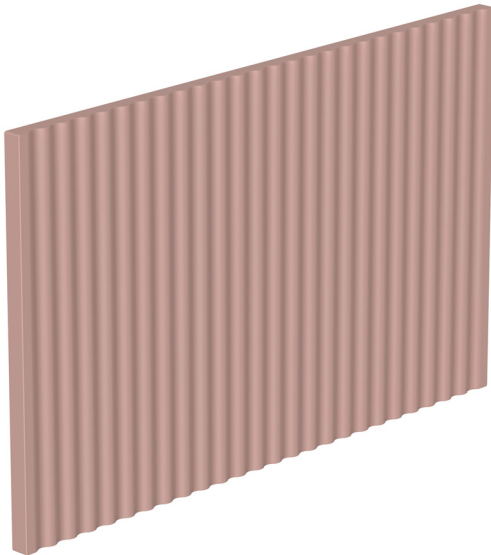

NEWPORT  
V-Groove Panels  
Code: NP

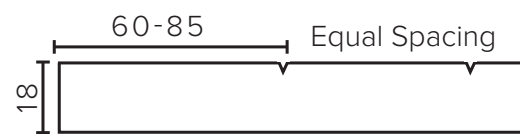
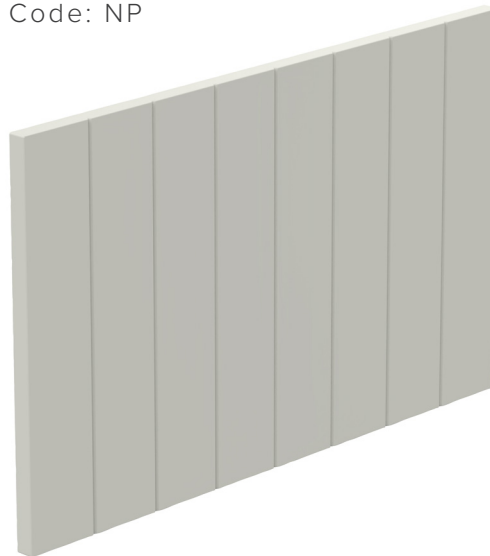

Seafoam



Iceberg

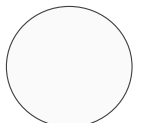

Snow White



Cherry Blossom



Slate Grey



Dusk Grey



Indigo



Matte Black

# SPECIFICATION SHEET

## 1500mm Single Basin Options

### Via

StoneCast with overflow

Gloss White - VIA

Matte White - VIAMW

W1500 x D460 x H20

