

SPECIFICATION SHEET

Porscha 500 1-Door Wall Hung Vanity



Features

- 1-Door Wall Hung Vanity - *Colour options below*
- 80mm StoneCast Interchangeable Basin
- Push-to-Open Door - Left Hinge Only
- Designer Door Front - *Four Door Front options*
- Dimensions
Cabinet: H400 x W495 x D243
Basin: H80 x W500 x D250

Cabinet Options

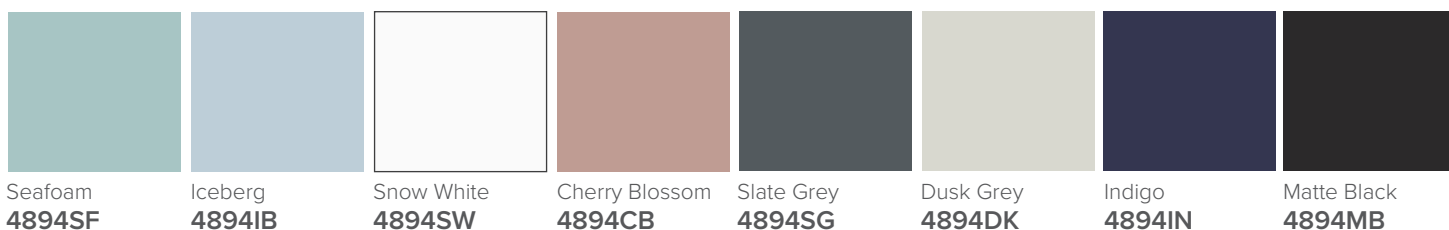

Technical Details

Note: All measurements shown are in millimetres. Sizes are nominal.

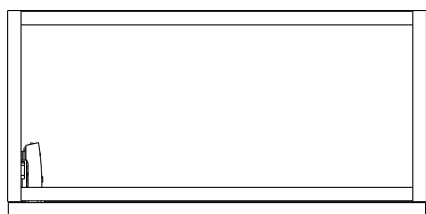

TOP VIEW

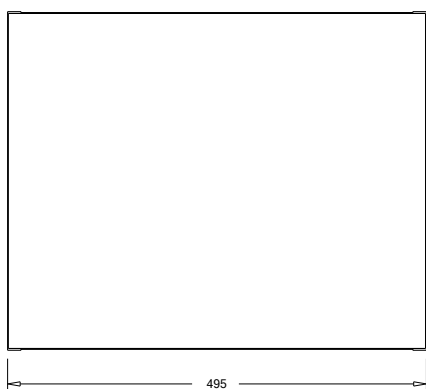
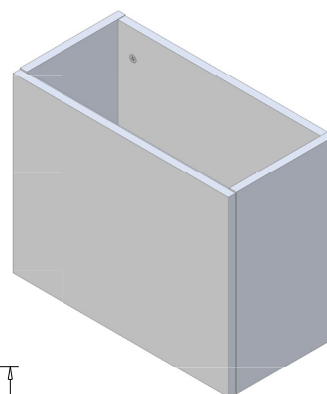

FRONT VIEW

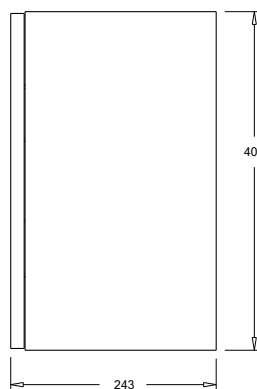

SIDE VIEW

SPECIFICATION SHEET

Porscha Designer Drawer Fronts

BARNSLEY
18mm Inset Frame
Code: BL

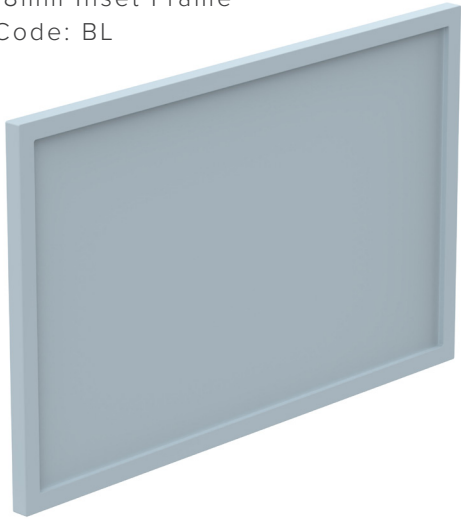

PRESTON
60mm Inset Frame
Code: PT

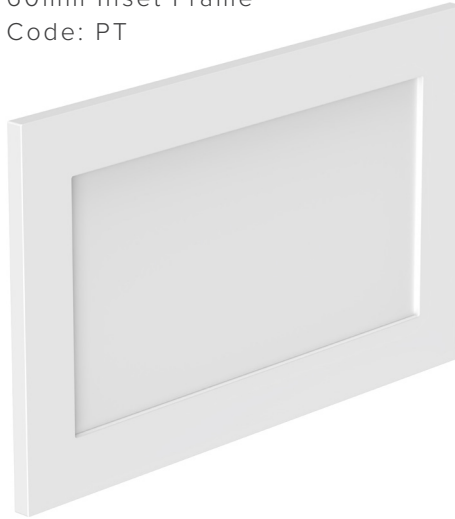

TURNBERRY
Ripple Design Panel
Code: TB

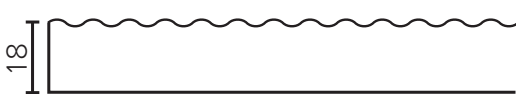

NEWPORT
V-Groove Panels
Code: NP

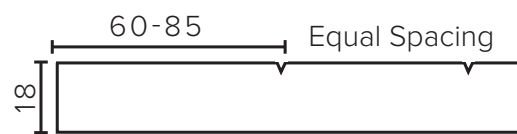

Seafoam



Iceberg

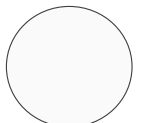

Snow White



Cherry Blossom



Slate Grey



Dusk Grey



Indigo



Matte Black