

SPECIFICATION SHEET

Porscha 900 1-Drawer Wall Hung Vanity



Features

- 1-Drawer Wall Hung Vanity - *Colour options below*
- StoneCast 20mm Via Basin [Standard] - *Upgrade options available*
- Full Extension Soft Close Drawer with Extrusion - *Extrusion upgrade options available*
- Designer Drawer Front - *Four Drawer Front options*
- Dimensions: H420 x W900 x D465

Cabinet Options

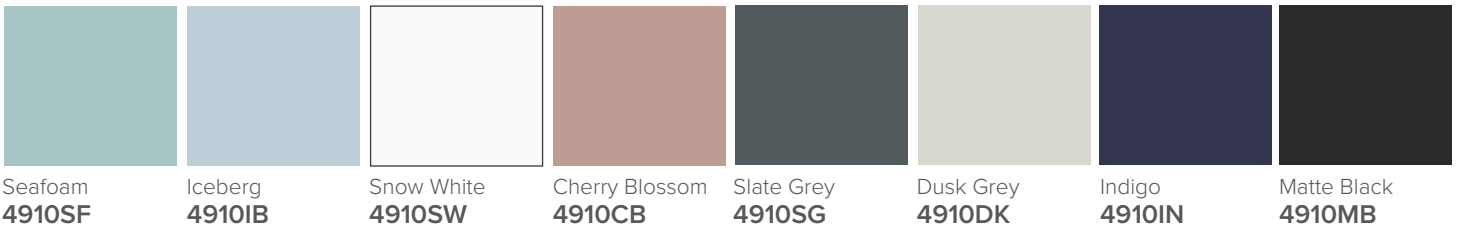

Technical Details

Note: All measurements shown are in millimetres. Sizes are nominal.

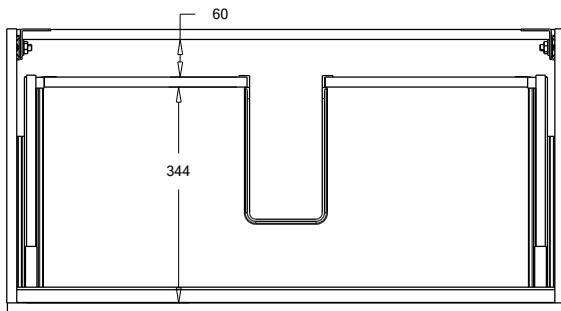

TOP VIEW

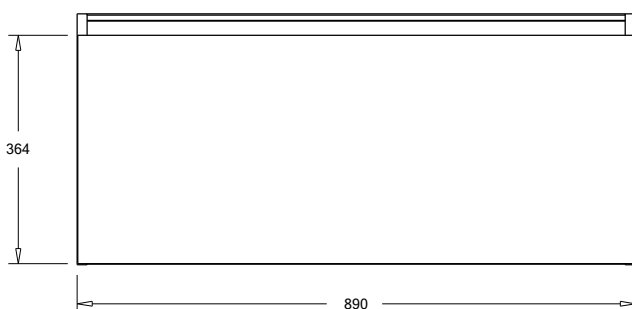
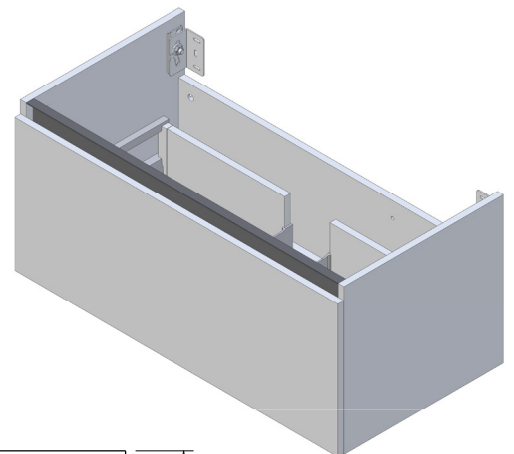

FRONT VIEW

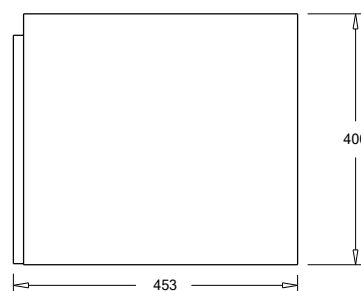

SIDE VIEW

SPECIFICATION SHEET

Porscha Designer Drawer Fronts

BARNSLEY
18mm Inset Frame
Code: BL

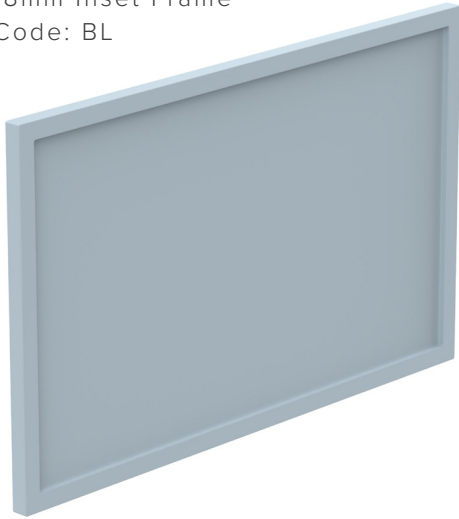

PRESTON
60mm Inset Frame
Code: PT

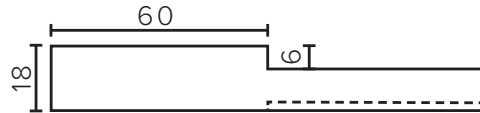
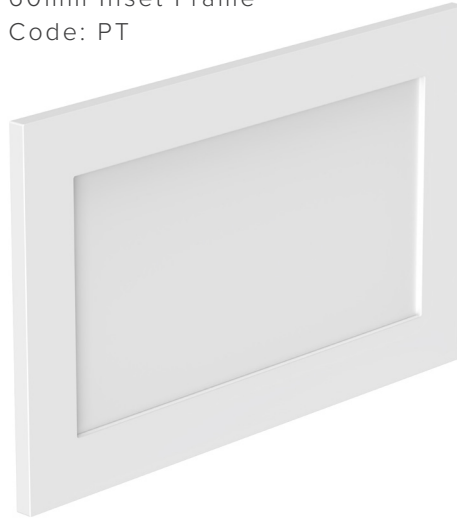

TURNBERRY
Ripple Design Panel
Code: TB

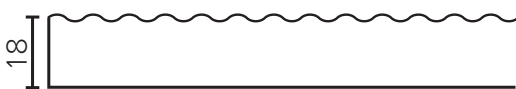
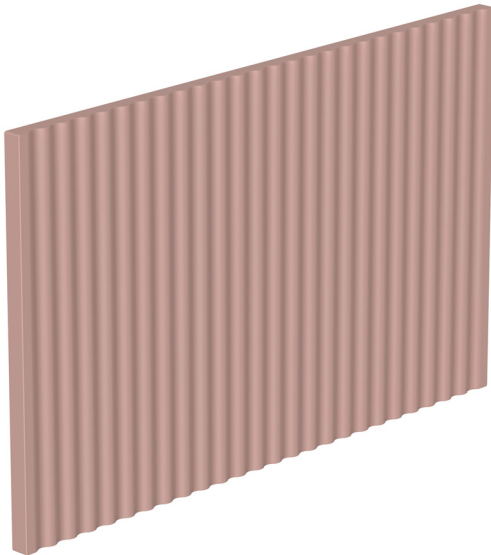

NEWPORT
V-Groove Panels
Code: NP

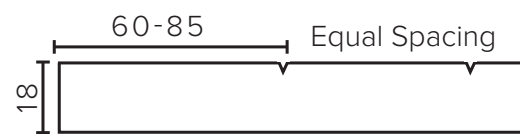
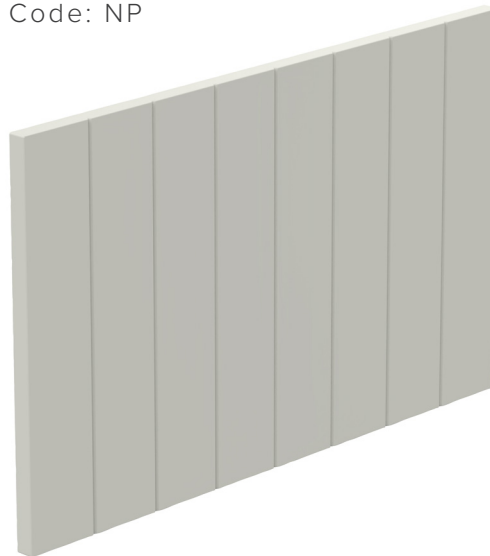

Seafoam



Iceberg



Snow White



Cherry Blossom



Slate Grey



Dusk Grey



Indigo



Matte Black

SPECIFICATION SHEET

900mm Basin Options

Via

StoneCast with overflow
Gloss White - VIA
Matte White - VIAMW

W900 x D460 x H20

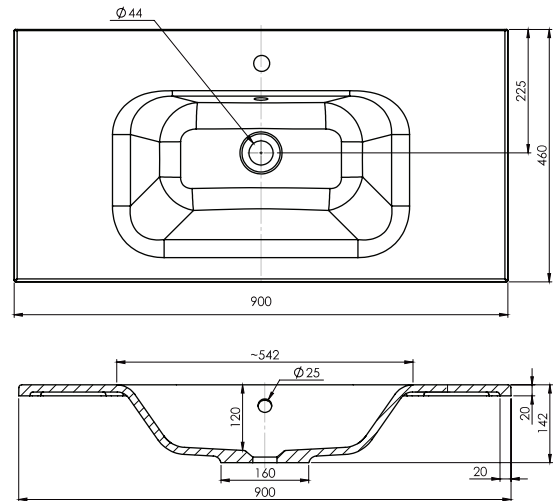
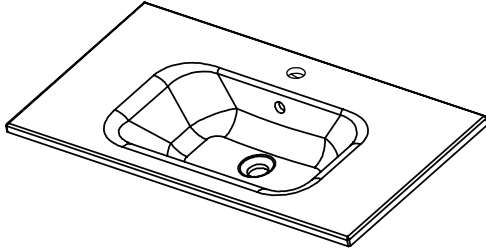

Clasico

Vitreous China with over low
Gloss White - VC

W910 x D465 x H20

