

# SPECIFICATION SHEET

## Skye 1500mm 4 Drawer Floor Vanity with Left Offset Basin



### Features

- Floorstanding
- Full Extension Soft Close Drawers
- Cabinet:  
Laminate Woodgrain & Solid Colours on MR Board
- Slab Top Options:  
20mm Quartz Top - Himalaya (H), Midnight Stone (MS)  
20mm StoneCast Top - Gloss White (SC), Matte White (SCMW)
- Dimensions: H820 x W1500 x D465
- Floor plumbing provision has been allowed for with a 60mm space behind lower drawer. Note lower drawers DO NOT have plumbing cutouts and are designed to offer full storage space.
- **Optional: Floor plumbing waste provision in bottom drawer [88515] - Additional \$75 RRP**

*Note: Vessel basins are purchased separately.  
Visit [www.newtech.co.nz](http://www.newtech.co.nz) for full range of vessel basin options.*

### Colour Options with Code

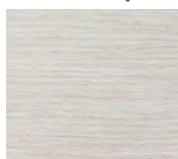

Alaskan  
97442LALS



Planked Urban Oak  
97442LPUO



Southern Oak  
97442LSTH

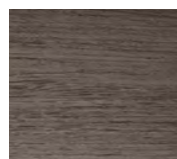

Charred Oak  
97442LCHO

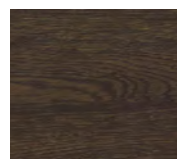

Borders Oak  
97442LBOK

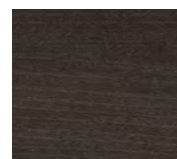

Burnished Wood  
97442LBWU

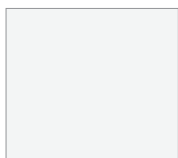

Gloss White  
97442LGW

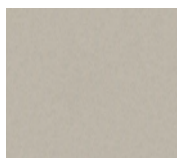

Dawn Grey  
97442LDGY



Spinifex  
97442LSPX

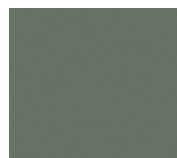

Green Slate  
97442LGRS

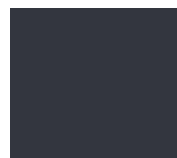

Char Blue  
97442LCBL

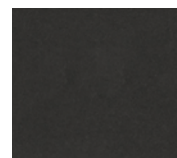

Bullet  
97442LBUL

### Technical Details

*Note: All measurements shown are in millimetres. Sizes are nominal.*

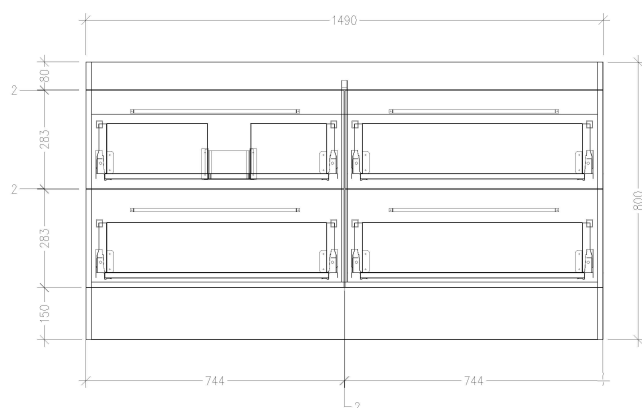

FRONT VIEW

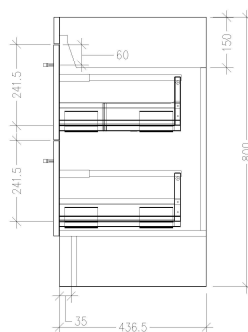

SIDE VIEW

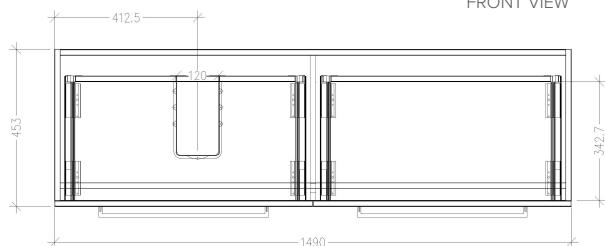

TOP VIEW

# SPECIFICATION SHEET

## Slab Top Options

### StoneCast Slab Top 1500

W1500 x D465 x H20

Gloss White - SC

Matte White - SCMW

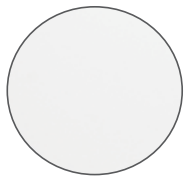
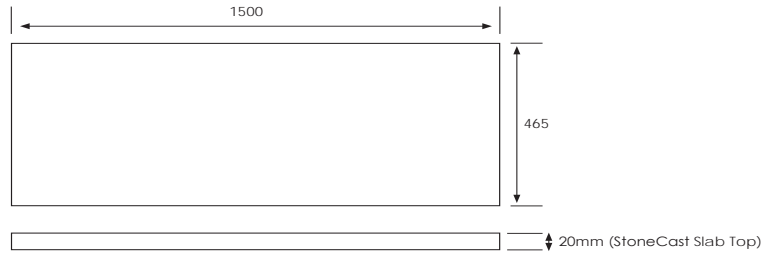
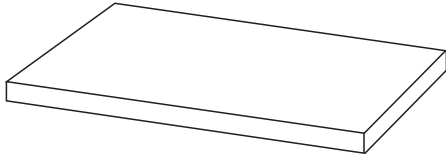

Gloss White



Matte White

### Quartz Slab Top 1500

W1500 x D465 x H20

Midnight Stone - MS

Himalaya - HY

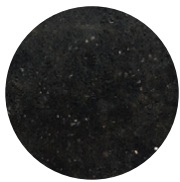
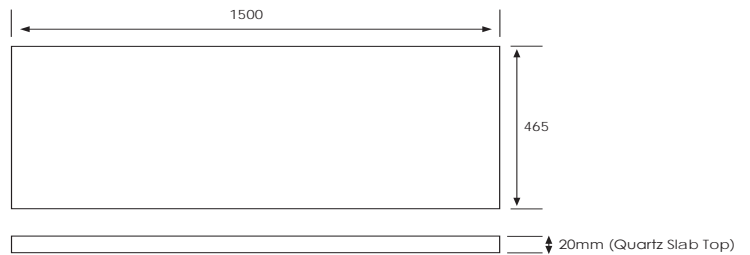
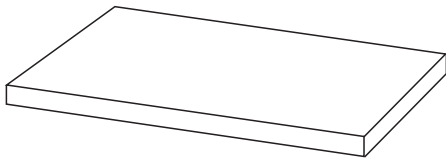

Midnight Stone

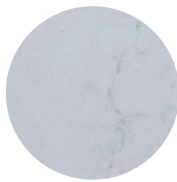

Himalaya

### Tap Hole Position

Tap hole position must be specified

- NTH** No Tap Holes
- CTH** Centre Tap Holes
- LTH** Left Tap Holes
- RTH** Right Tap Holes
- ITH\*** Inside Tap Holes
- OTH\*** Outside Tap Holes

\*only applicable with double basins