

SPECIFICATION SHEET

Vega 1500mm 2 Drawer Single Basin Wall Vanity



Features

- Wall Hung
- Full Extension Soft Close Drawers
- Negative detail finger pull with extrusion
- Cabinet:
Laminate Woodgrain &
Solid Colours on MR Board
- Slab Top Options:
20mm Quartz Top
20mm StoneCast Top
- Dimensions: H420 x W1500 x D465

*Note: Vessel basins are purchased separately.
Visit www.newtech.co.nz for full range of vessel basin options.*

Colour Options with Code

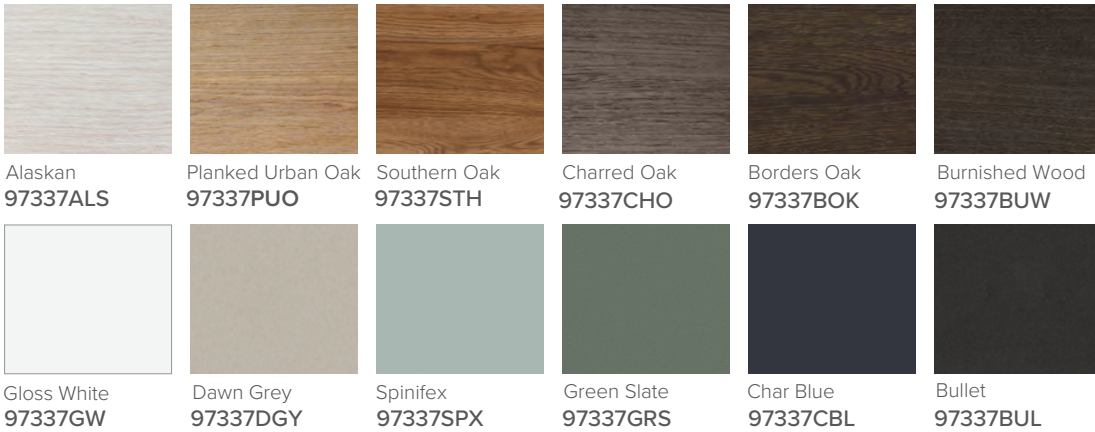

Technical Details

Note: All measurements shown are in millimetres. Sizes are nominal.

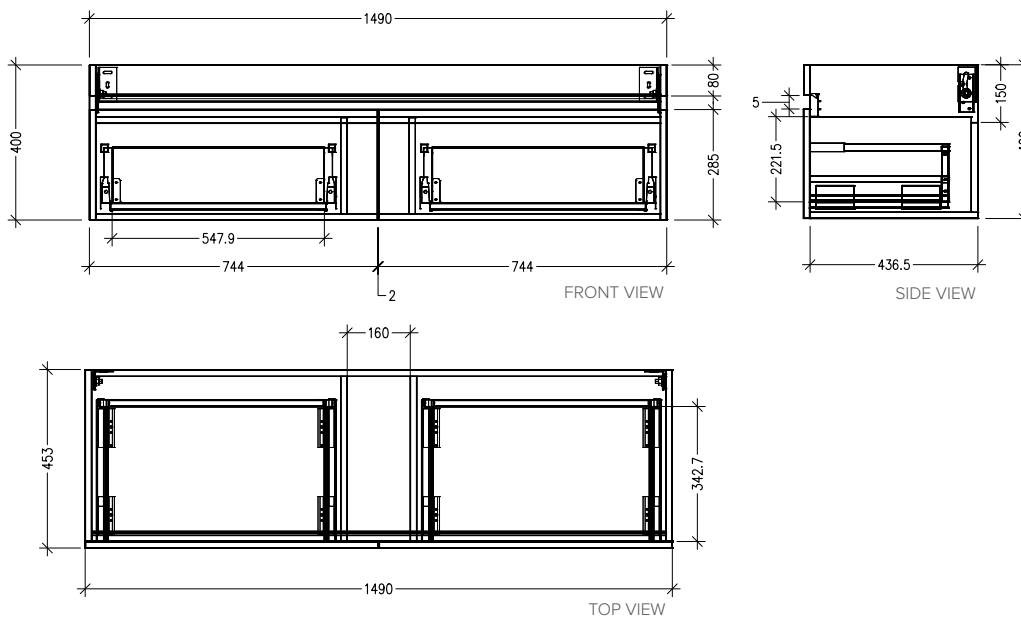

SPECIFICATION SHEET

Slab Top Options

StoneCast Slab Top 1500

W1500 x D465 x H20

Gloss White - SC

Matte White - SCMW

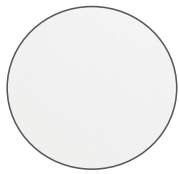
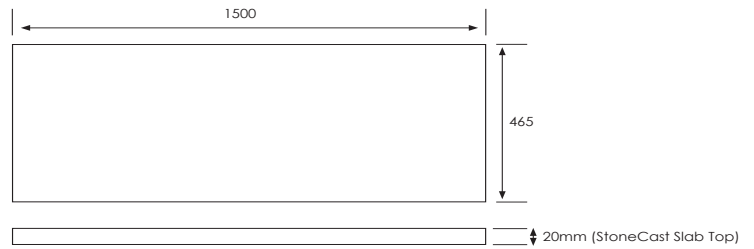
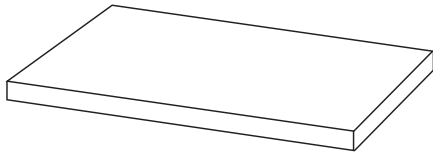

Gloss White

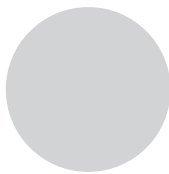

Matte White

Quartz Slab Top 1500

W1500 x D465 x H20

Midnight Stone - MS

Himalaya - HY

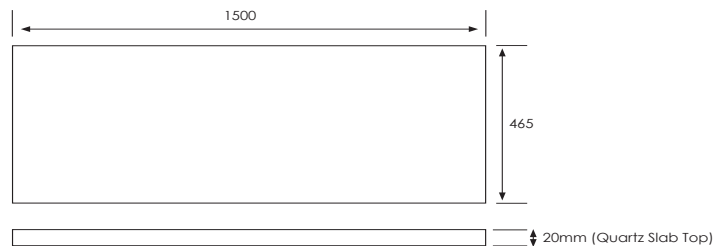
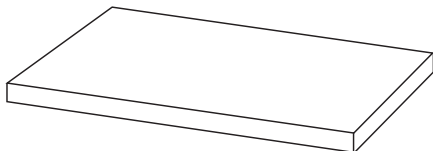

Midnight Stone



Himalaya

Tap Hole Position

Tap hole position must be specified

| | |
|-------------|-------------------|
| NTH | No Tap Holes |
| CTH | Centre Tap Holes |
| LTH | Left Tap Holes |
| RTH | Right Tap Holes |
| ITH* | Inside Tap Holes |
| OTH* | Outside Tap Holes |

*only applicable with double basins